

YOUR TRUSTED PERFORMANCE PARTNER.

DANLOGGROUP.COM
sales@danloggroup.com

725 Drennan St.
Houston, TX 77003
+1 800-231-6355
+1 713-356-3500



Threaded Products | Fasteners & Gaskets | Precision Machining



STYLE RX

RX ring joint gaskets are a pressure-energized modification of the standard style R ring joint gasket. RX gaskets are designed to fit the same flange grooves as a standard style R.

PERFORMANCE THAT COUNTS.

A* width of ring	+/- 0.008,-0.000
H* height of ring	+/- 0.008,-0.000
OD (outside diameter of ring)	+/- 0.020,-0.000
23° (angle)	+/- 1/2°
Tolerances: (inches)	

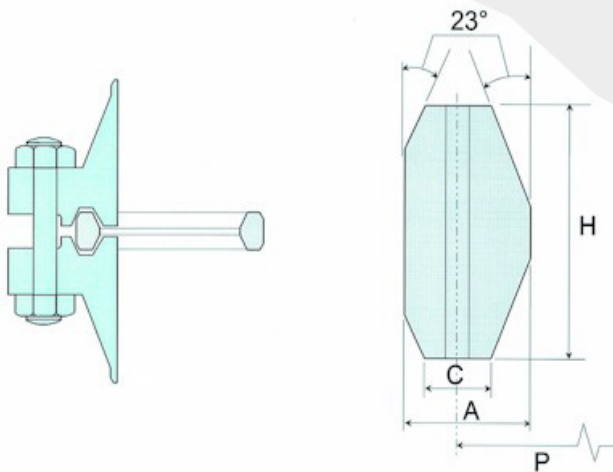
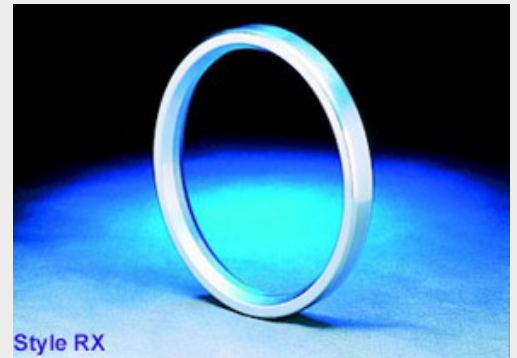

* A plus tolerance of 0.008" for width 'A' and height 'H' is permitted provided the variation in width or height does not exceed 0.004" throughout its entire circumference.

Note: The pressure passage hole illustrated in the RX Ring Cross section is in Rings RX82 through RX91 only. Center line of hole shall be located at mid point of dimension 'C' (width of flat).

* API allows more liberal tolerances on RX 201-215

WE PERFORM SO YOU CAN PERFORM.

Ring No.	Pressure Class Ratings			Pitch Diameter of Ring	Outside Diameter of Ring	Width of Ring	Height of Ring	Weight lbs
	2000	3000	5000					
	Nominal Pipe Size			P	OD	A	H	
RX20	-	-	-	2.688	3.000	0.344	0.750	0.527
RX20	-	-	2 1/16	2.688	3.000	0.344	0.750	0.527
RX23	2 1/16	-	-	3.250	3.672	0.469	1.000	1.150
RX24	-	2 1/16	2 1/16	3.750	4.172	0.469	1.000	1.330
RX25	-	-	3 1/8	4.000	4.313	0.344	0.750	1.420
RX26	2 9/16	-	-	4.000	4.406	0.469	1.000	1.500
RX27	-	2 9/16	2 9/16	4.250	4.656	0.469	1.000	1.730
RX31	3 1/8	3 1/8	-	4.875	5.297	0.469	1.000	1.910
RX35	-	-	3 1/8	5.375	5.797	0.469	1.000	2.090
RX37	4 1/16	4 1/16	-	5.875	6.297	0.469	1.000	2.270
RX39	-	-	4 1/16	6.375	6.797	0.469	1.000	2.540
RX41	-	-	-	7.125	7.547	0.469	1.000	2.720
RX44	-	-	-	7.625	8.047	0.469	1.000	2.960
RX45	7 1/16	7 1/16	-	8.313	8.734	0.469	1.000	3.660
RX46	-	-	7 1/16	8.313	8.750	0.531	1.125	8.560
RX47	-	-	-	9.000	9.656	0.781	1.625	3.790
RX49	9	9	-	10.625	11.047	0.469	1.000	5.360
RX50	-	-	9	10.625	11.156	0.656	1.250	4.560
RX53	11	11	-	12.750	13.172	0.469	1.000	6.450
RX54	-	-	11	12.750	13.281	0.656	1.250	5.360
RX57	13 5/8	13 5/8	-	15.000	15.422	0.469	1.000	26.400
RX63	-	-	-	16.500	17.391	1.063	2.000	6.630
RX65	16 3/4	-	-	18.500	18.922	0.469	1.000	9.390
RX66	-	16 3/4	-	18.500	50.031	0.656	1.250	7.520
RX69	-	-	-	21.000	21.422	0.469	1.000	20.140
RX70	-	-	-	21.000	21.656	0.781	1.625	11.630
RX73	21 1/4	-	-	23.000	23.469	0.531	1.250	22.100
RX74	-	20 3/4	-	23.000	23.656	0.781	1.625	0.790
RX82	-	-	-	2.250	2.672	0.469	1.000	0.880
RX84	-	-	-	2.500	2.922	0.469	1.000	0.880
RX85	-	-	-	3.125	3.547	0.531	1.000	1.790
RX86	-	-	-	3.563	4.078	0.594	1.125	1.980
RX87	-	-	-	3.938	4.453	0.594	1.125	3.220
RX88	-	-	-	4.875	5.484	0.688	1.250	2.980
RX89	-	-	-	4.500	5.109	0.719	1.250	6.820
RX90	-	-	-	6.125	6.875	0.781	1.750	17.100
RX91	-	-	-	10.250	11.297	1.188	1.781	3.310
RX99	-	-	-	9.250	9.672	0.469	1.000	-
RX201*	-	-	1 3/8	1.813	2.026	0.226	0.445	-
RX205*	-	-	1 13/16	2.250	2.453	0.219	0.437	-
RX210*	-	-	2 9/16	3.500	3.844	0.375	0.750	-
RX215*	-	-	4 1/16	5.125	5.547	0.469	1.000	-
RX215*	-	-	4 1/16 x 4 1/4	5.125	5.547	0.469	1.000	-